

Prince 3



Prince 3

The Prince 3 series, with its unique cross-beam optical design, effectively suppresses stray light, thereby creating a clear and perfectly round light spot.

The floating lens design allows a single luminaire to function as both a fixed downlight and an adjustable downlight, enabling changes in illumination direction in both the vertical (25°) and horizontal (360°) planes without rotating the heat sink.



Cross Lighting Design
Light Control is More Precise



Suspension Lens Adjustment

360° flexible adjustment
30° precise orientation in vertical plane



Innovative Installation Of Applications

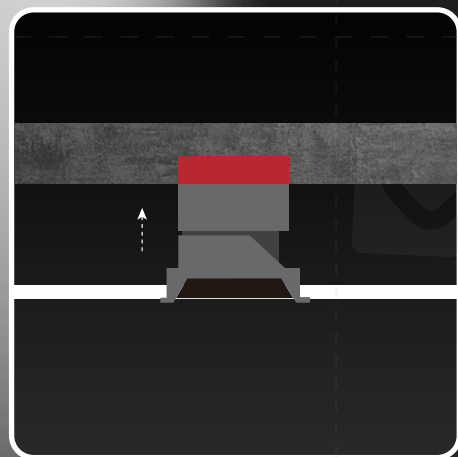

Ceiling cavity depth
is unrestricted

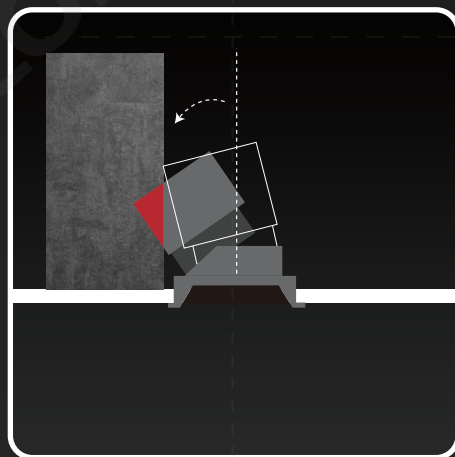

Vertical adjustment
is unrestricted

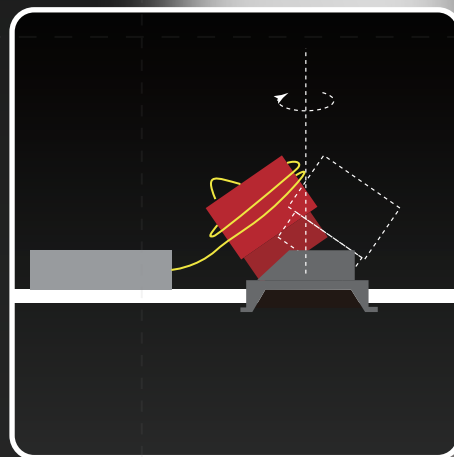

Horizontal adjustment
is unrestricted

Anti-glare For A More Comfortable Experience

MIN UGR<3



Deeply Recessed Light Source
Instant Anti-Glare on Output

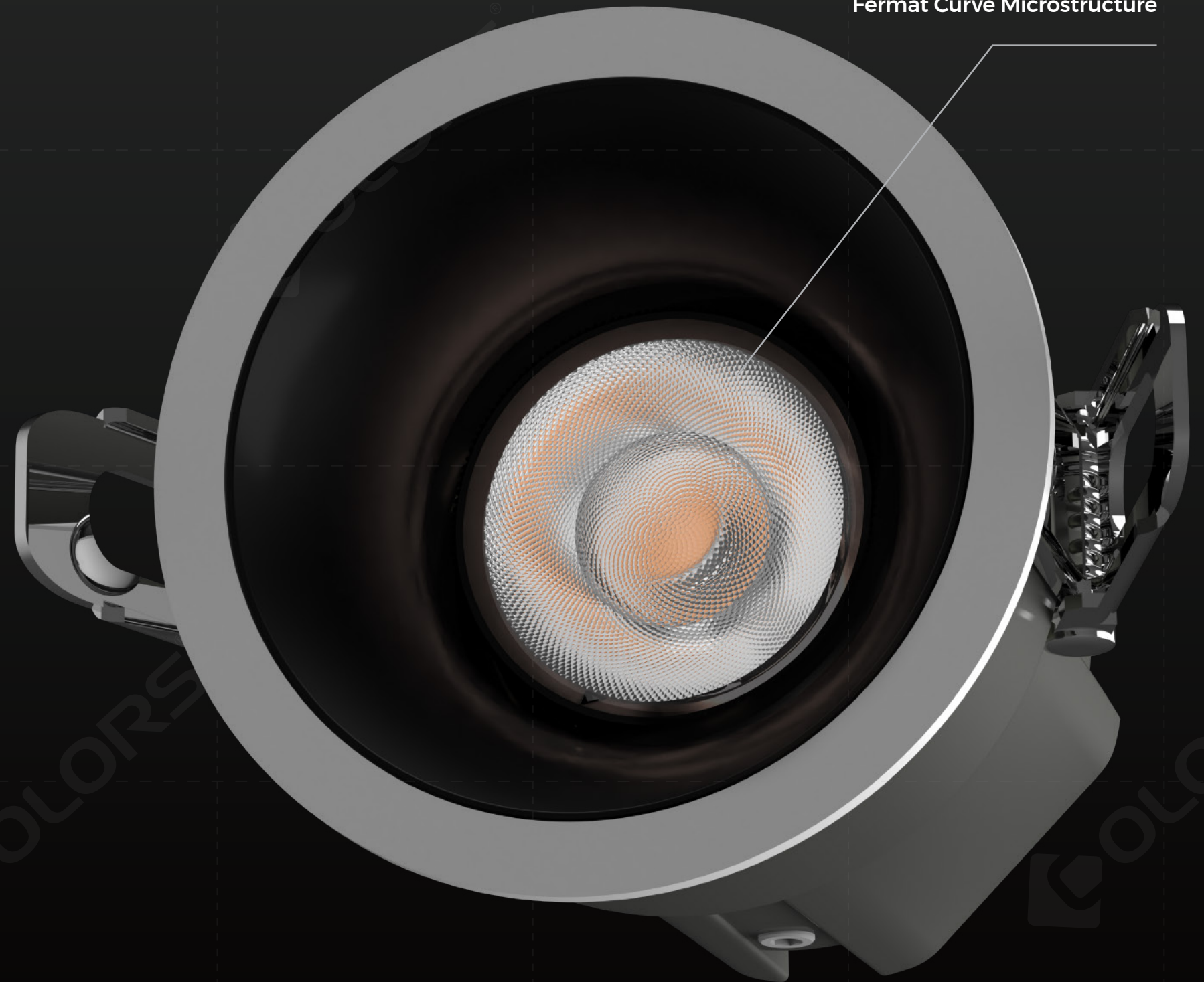

Fermat Curve Microstructure

Full Aluminum Alloy One-Piece Lamp Body High-Efficiency Heat Dissipation



Heat dissipation improved by 20%



Light Decay Reduced by 20%



Lifespan extended by 40%



Energy-Saving and More Environmentally Friendly

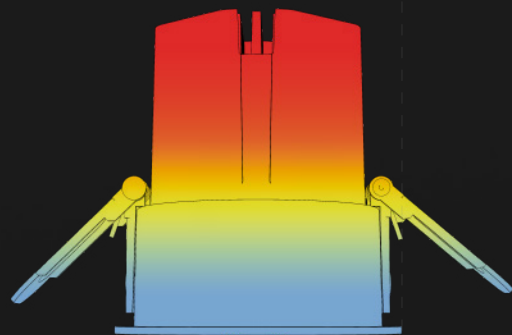

High efficient heat conduct material are used to ensure long lifespan and minimize light output decay.

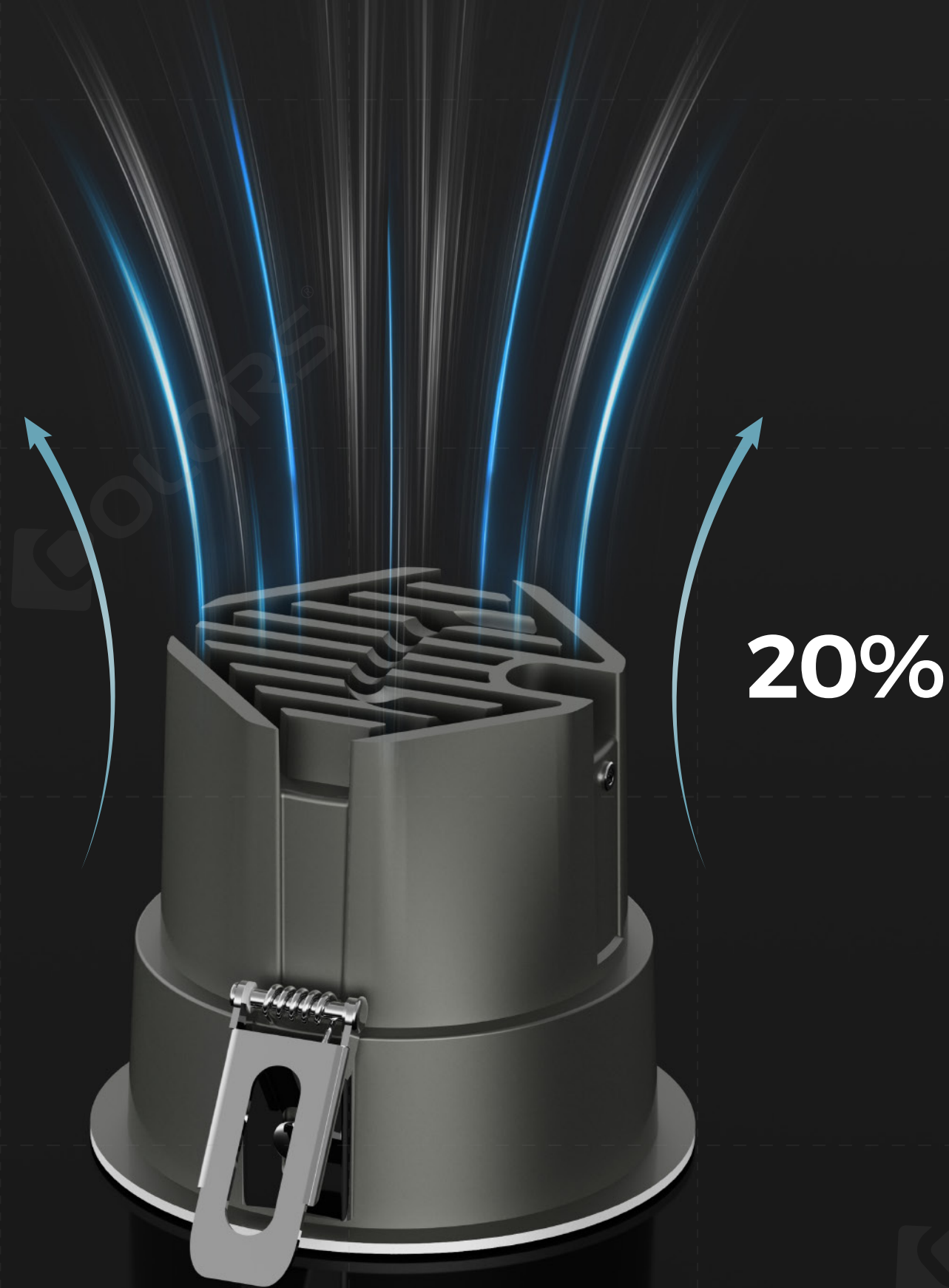

Recommended Applications

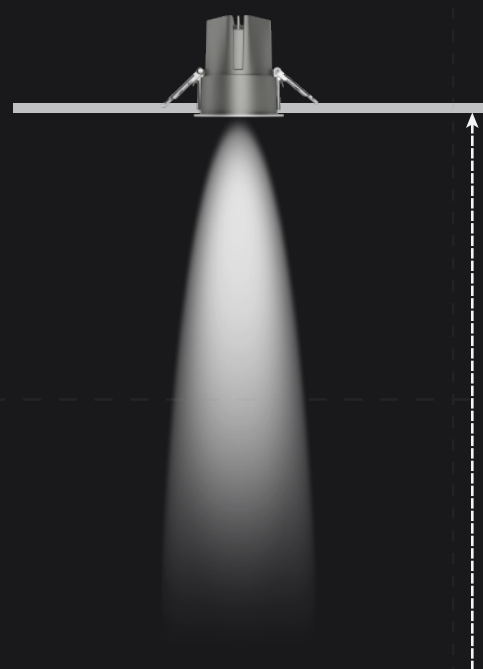

φ55mm
Max 9W
20° / 30°



φ75mm
Max 12W
24° / 36°

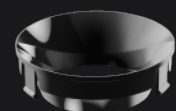

Black chrome

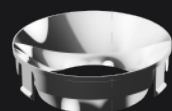

Mirror



Matte black



Matte white





SKU	Opening	Power	Input Voltage	Output Voltage	Input Current(LED)	CRI	CCT	Beam Angle	luminous Efficacy (lm/w)	Luminous Flux (lm)	SDCM	UGR
P3E55L2	Φ55mm	6W	220-240V	36V	150mA	90	3000K	20°	56	335	<3	<8
			220-240V	36V	150mA	90	3000K	30°	58	350	≤3	≤8
		9W	220-240V	36V	200mA	90	3000K	20°	51	460	≤3	≤8
			220-240V	36V	200mA	90	3000K	30°	55	495	≤3	≤8
P3E75L2	Φ75mm	9W	220-240V	36V	200mA	90	3000K	24°	66	595	<3	<3
			220-240V	36V	200mA	90	3000K	24°	70	630	≤3	≤10
		12W	220-240V	36V	300mA	90	3000K	36°	65	780	≤3	≤3
			220-240V	36V	300mA	90	3000K	36°	68	815	≤3	≤10



Tel: +86-755-2923-1888

E-mail: colors@colorsled.com

Web: www.colorsled.com

Add: 17F, Block B, Building 2, North of Skyworth

Inno Valley, Shiyan town, Bao'an District, Shenzhen